



## Rack and pinion passenger/goods hoist

Without counterweight - single or twin operation (1 or 2 cages)

### PEGA 2840 TD VFC

#### TECHNICAL DATA

##### CAPACITY PER CAGE

Payload capacity	2800 kg
Passengers	30
Erection load	1000 kg
Speed	0-100 m/min
Rated lifting height	0-420 m
Maximum tie spacing	12 m

##### DIMENSIONS PER CAGE

Internal width x length	1,5 x 4,0 m
Internal minimum height	2,49 m
Door opening w x h	1,43 x 2,0 m
Mast section length	1,508 m

##### ELECTRICAL DATA PER CAGE

Power supply	380-460V 3Ph 50/60 Hz
Power supply fuses	80-160 A
Rated power	45-90 kW
Starting current	90-180 A
Running current (40% duty)	70-139 A
Power consumption	47-92 kVA

##### WEIGHTS PER CAGE

Base unit and enclosure	4200 kg
Cage weight	3100 kg
Mast section with 2 racks	175-215 kg

##### CONTROL SYSTEM

Joystick/ Push button/ Key pad control  
Preprogrammable floor stops  
Other control systems on request

General:

All lifts equipped with frequency controlled drives  
and programmable control systems

Cable basket or cable trolley operation

Variety of optional equipment

Different masts and tie- systems to meet all kind of application demands

Doors installations in different positions and combinations

The above specification may vary based on country and region of delivery.

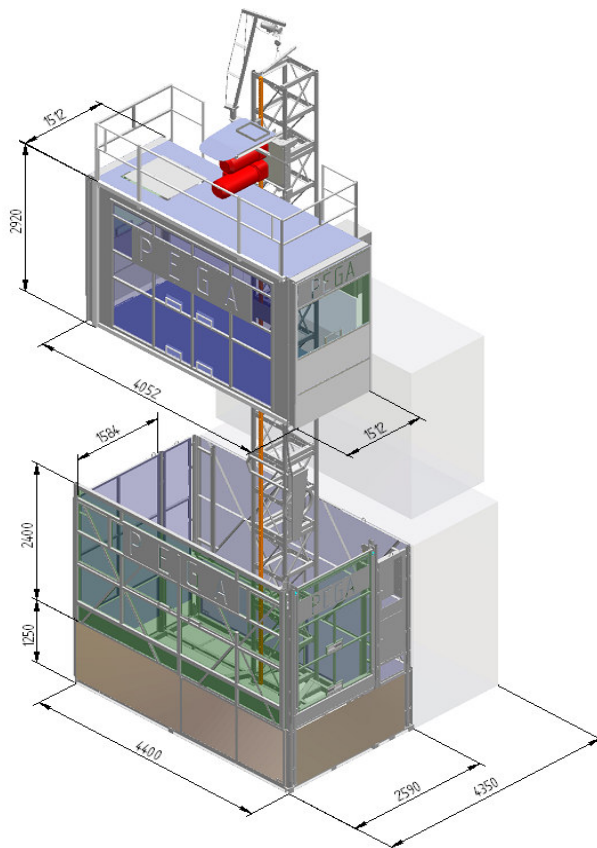

## CONSULT - RENT - SALE - SERVICE

#### PEGA HOIST Ltd.

Fablovka 547  
CZ - 533 52 Pardubice  
Tel. : +420 466 536 348, 466 536 350  
Fax : +420 466 536 351  
E-mail : info@pega-hoist.com  
www.pega-hoist.com

Local representative

The technical data above are for information only. The manufacturer reserves the right to change the parameters subject to continuous development and improvements.