



## Rack and pinion passenger/goods hoist

Without counterweight - single or twin operation (1 or 2 cages)

### PEGA 2837 TD VFC

#### TECHNICAL DATA

##### CAPACITY PER CAGE

Payload capacity	6000 lb
Passengers	28
Erection load	2200 lb
Speed	0-328 ft/min
Rated lifting height	0-1380 ft
Maximum tie spacing	34 ft

##### DIMENSIONS PER CAGE

Internal width x length	4'-11,1"x12'-1,7"
Internal minimum height	8'-2"
Door opening w x h	4'-8,3"x6'-6,7"
Mast section length	4'-11,4"

##### ELECTRICAL DATA PER CAGE

Power supply	380-460V 3Ph 50/60 Hz
Power supply fuses	80-160 A
Rated power	45-75 kW
Starting current	88-144 A
Running current (40% duty)	69-111 A
Power consumption	47-79 kVA

##### WEIGHTS PER CAGE

Base unit and enclosure	8820 lb
Cage weight	6400 lb
Mast section with 2 racks	386-474 lb

##### CONTROL SYSTEM

Joystick/ Push button/ Key pad control  
Preprogrammable floor stops  
Other control systems on request

Generall:

All lifts equipped with frequency controlled drives  
and programmable control systems

Cable basket or cable trolley operation

Variety of optional equipment

Different masts and tie- systems to meet all kind of application demands

Doors installations in different positions and combinations

The above specification may vary based on country and region of delivery.

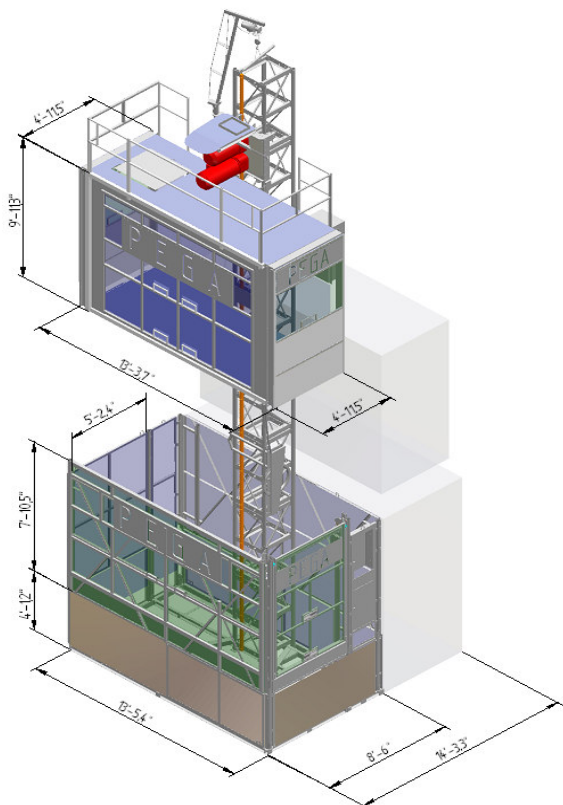

### CONSULT - RENT - SALE - SERVICE

#### PEGA HOIST Ltd.

Fablovka 547  
CZ - 533 52 Pardubice  
Tel. : +420 466 536 348, 466 536 350  
Fax : +420 466 536 351  
E-mail : info@pega-hoist.com  
www.pega-hoist.com

Local representative

The technical data above are for information only. The manufacturer reserves the right to change the parameters subject to continuous development and improvements.